

INST_14_96



Nr. 4, 5



Nr. 10,13

Nr	Σ	Element		
2	12		-	W6x60
10	12		DIN 9021	6x18
16	22		-	K1_d21_B
17	22		-	Z1_d21_B
18	12		DIN 985	M6 (OC)
21	14		DIN 125	8x16
28	4		ISO 7380	M8x25
31	4		DIN 985	M8 (OC)
58	1		-	LOCTITE
132	12		DIN 7991	M6x25
240	6		DIN 933	M8x25 (OC)

1

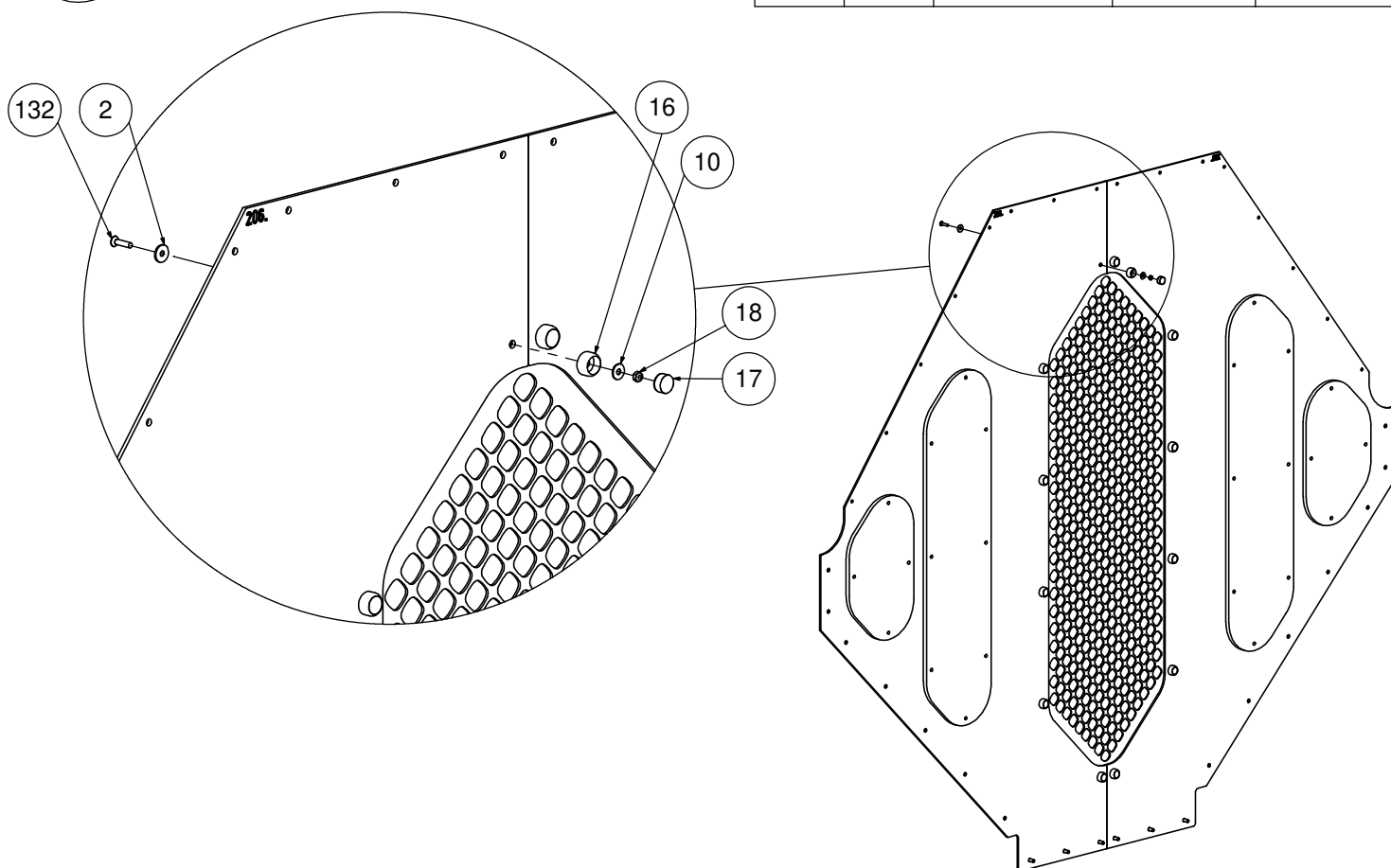

2

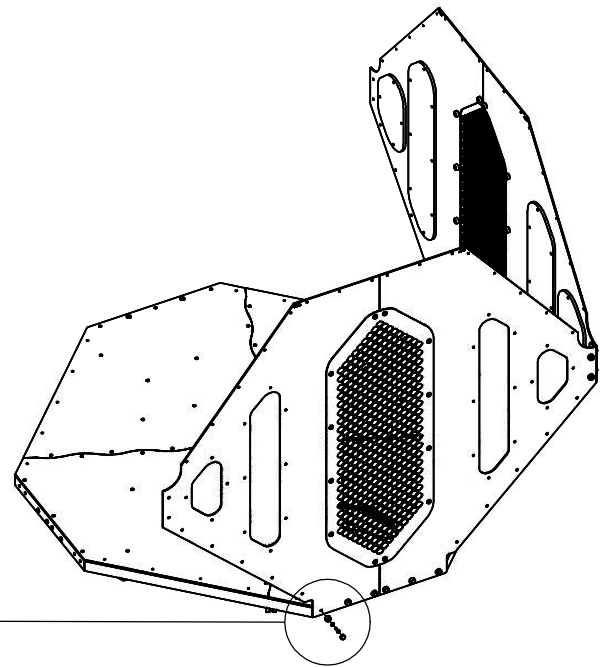
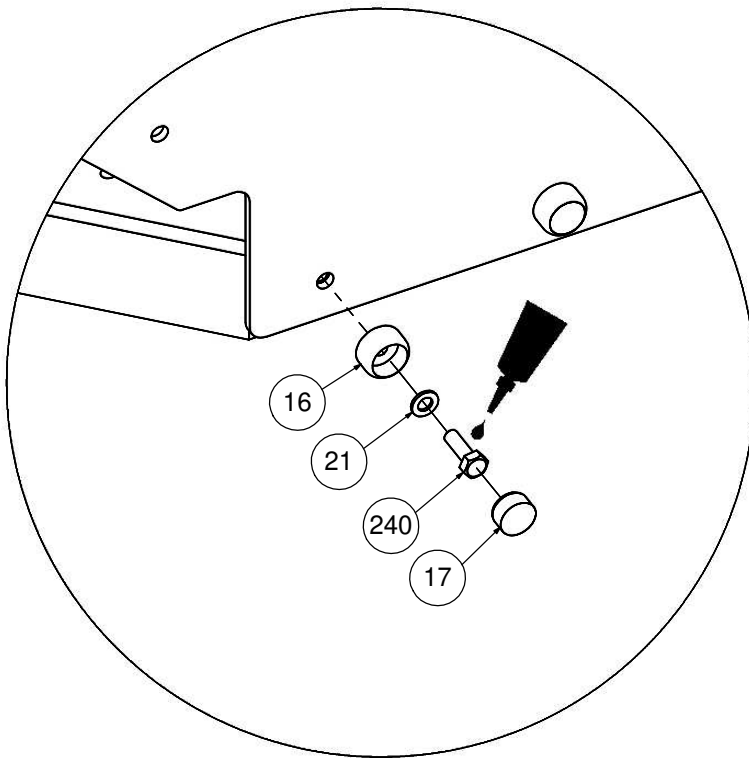

3

