

INST_12_27



Nr. 5

Nr. 13

Nr. 10

1

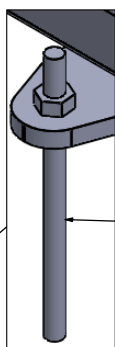
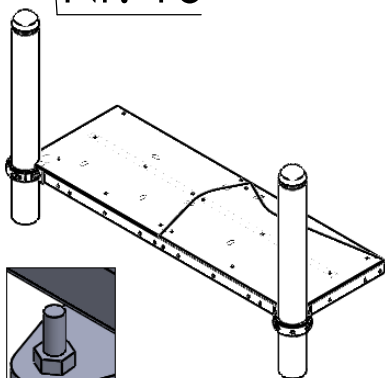

61

F5

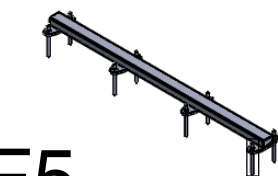

207

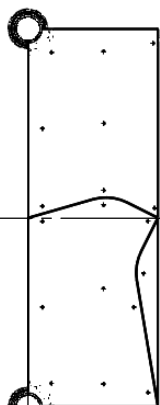

Nr	Σ	Element		
16	6		-	K1_d21_B
17	6		-	Z1_d21_B
21	10		DIN 125	8x16
31	6		DIN 985	M8 (OC)
58	1		-	LOCTITE
61	8		-	KL105 (OC)
116	6		ISO 7380	M8x55
218	6		NYLON DIN 125	8x16
250	4		DIN 7504K	6,3x32

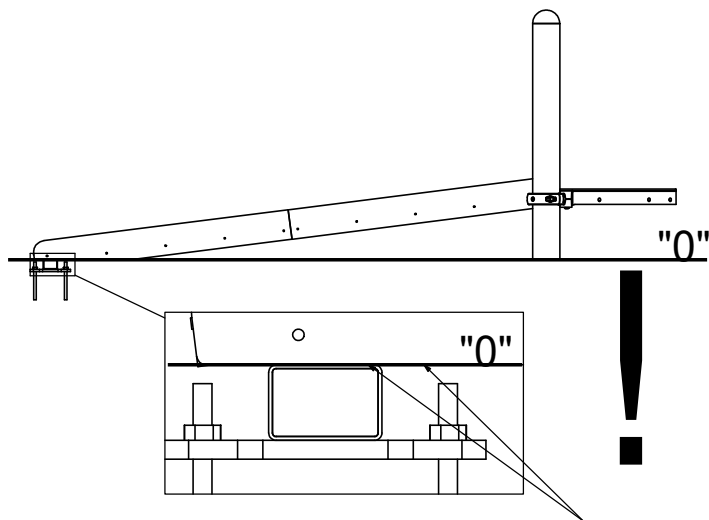

F10

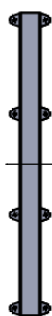

206

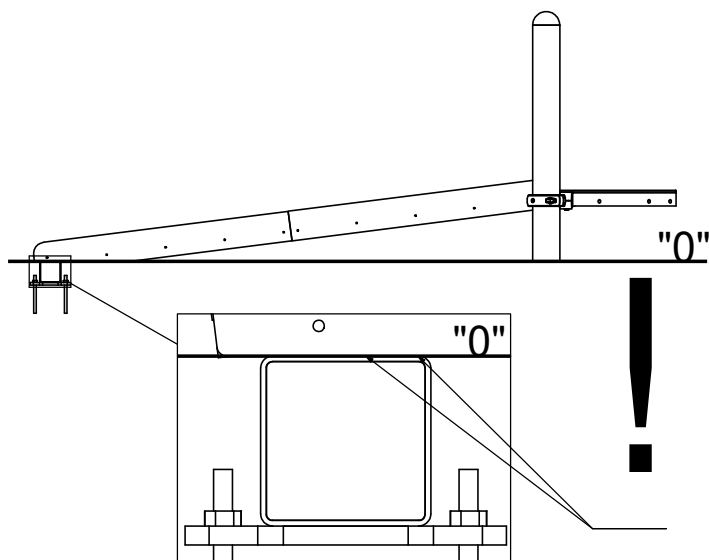
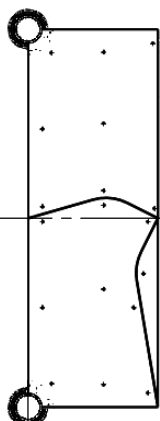

2

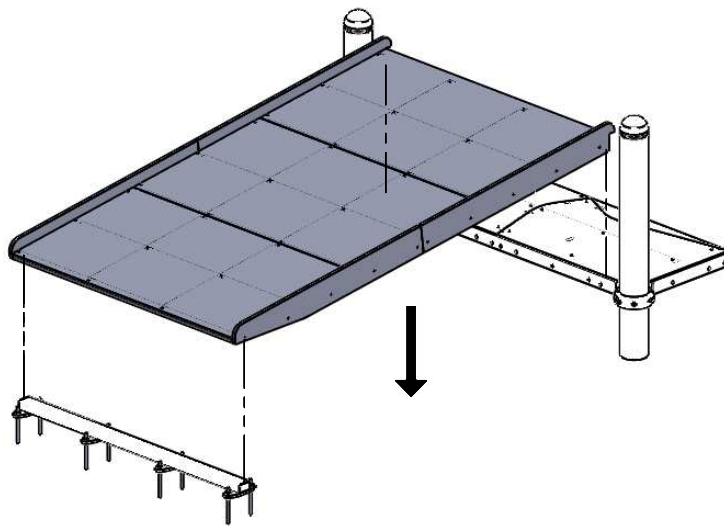

3

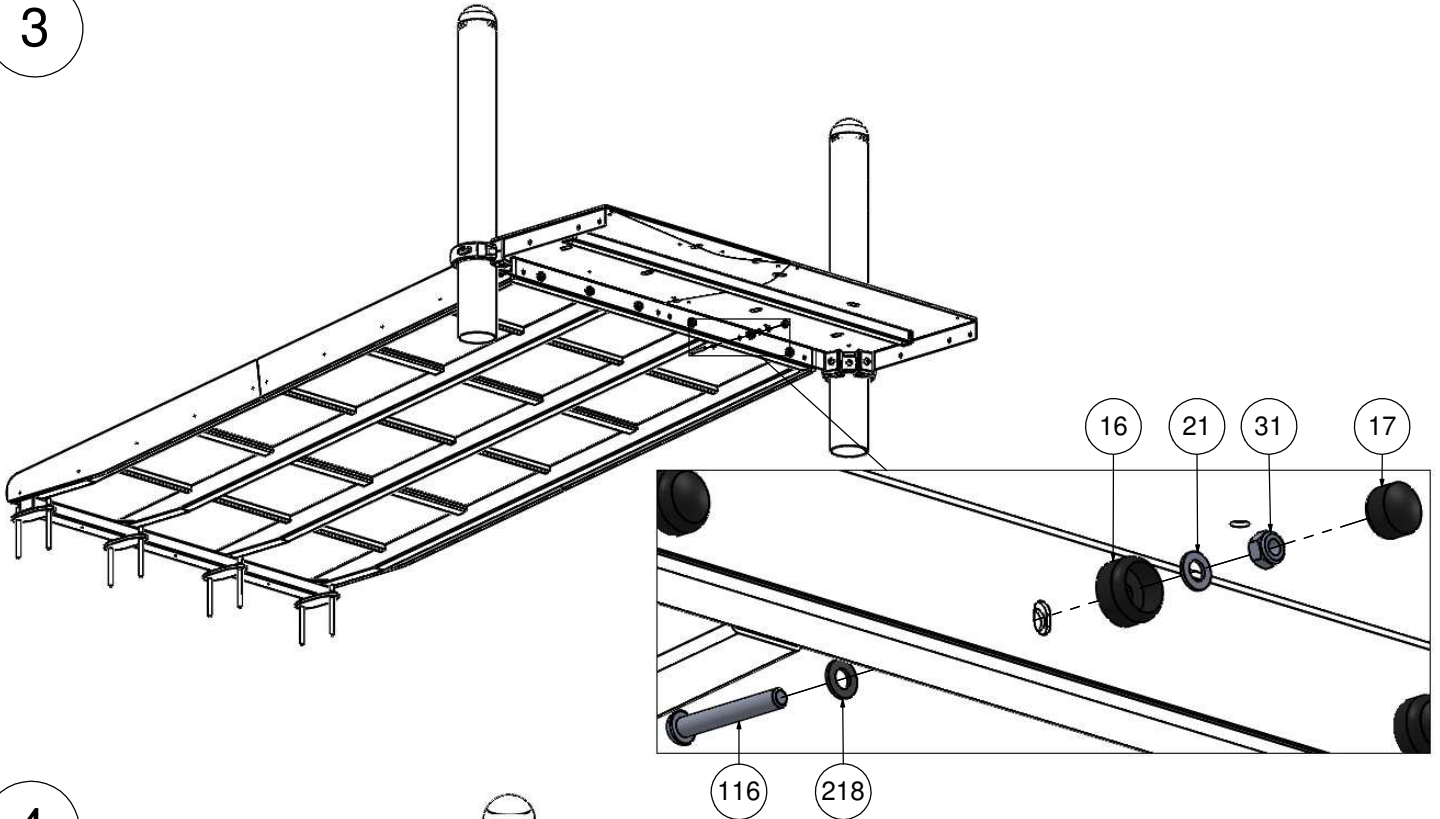

4

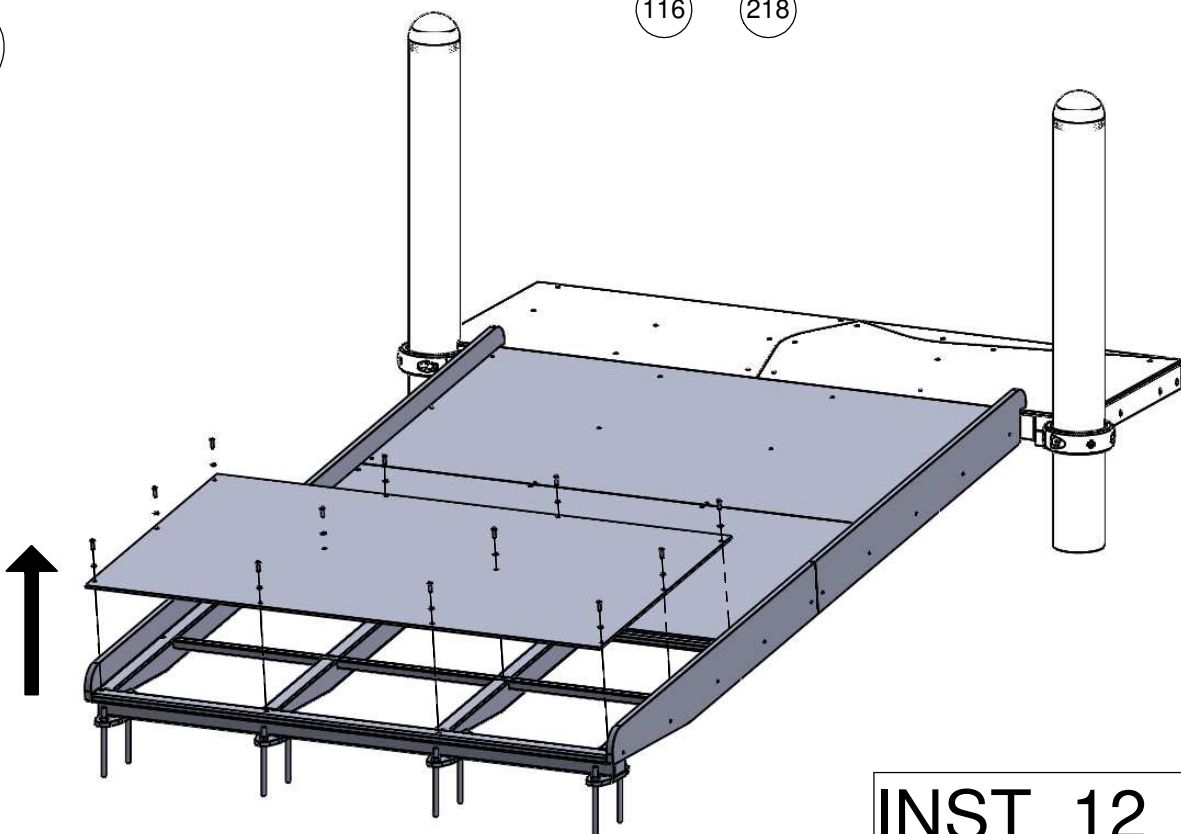

5

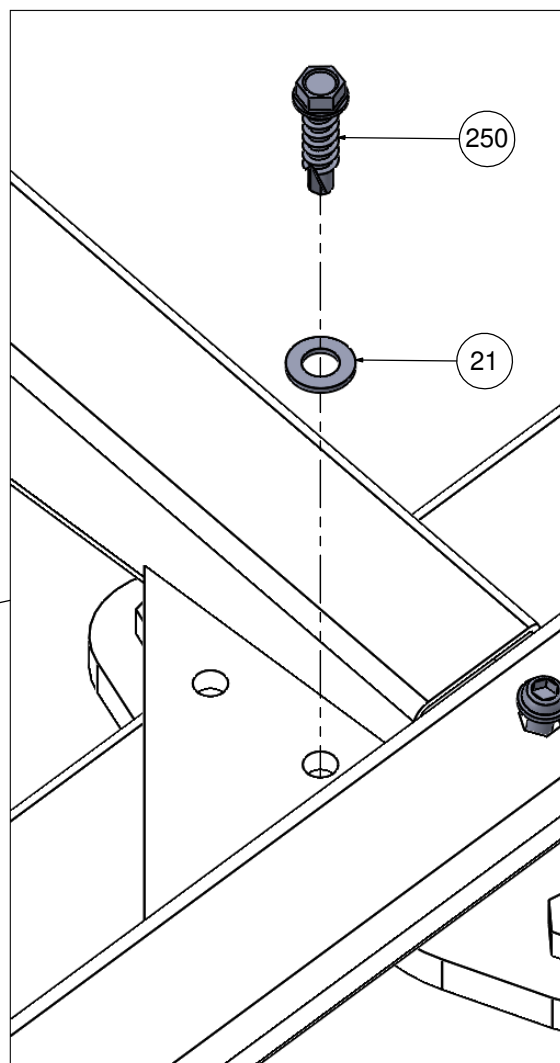
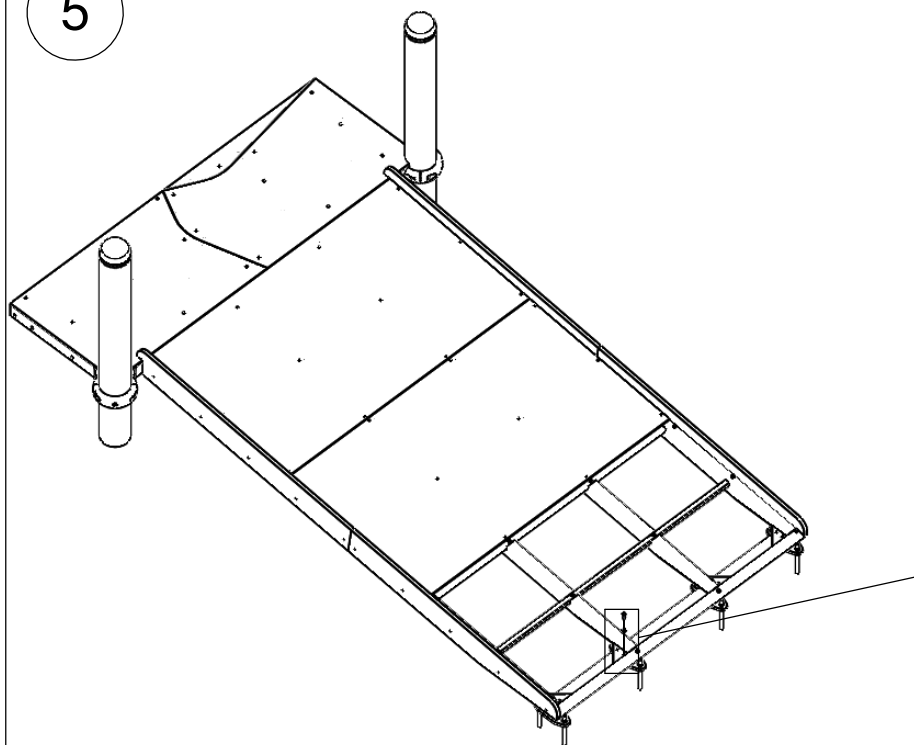

6

